

2101-5 Soudan Ave, Toronto, ON

Main Floor Total Interior Area 631 sq ft

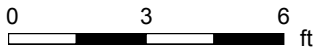

PREPARED: Jun, 2020

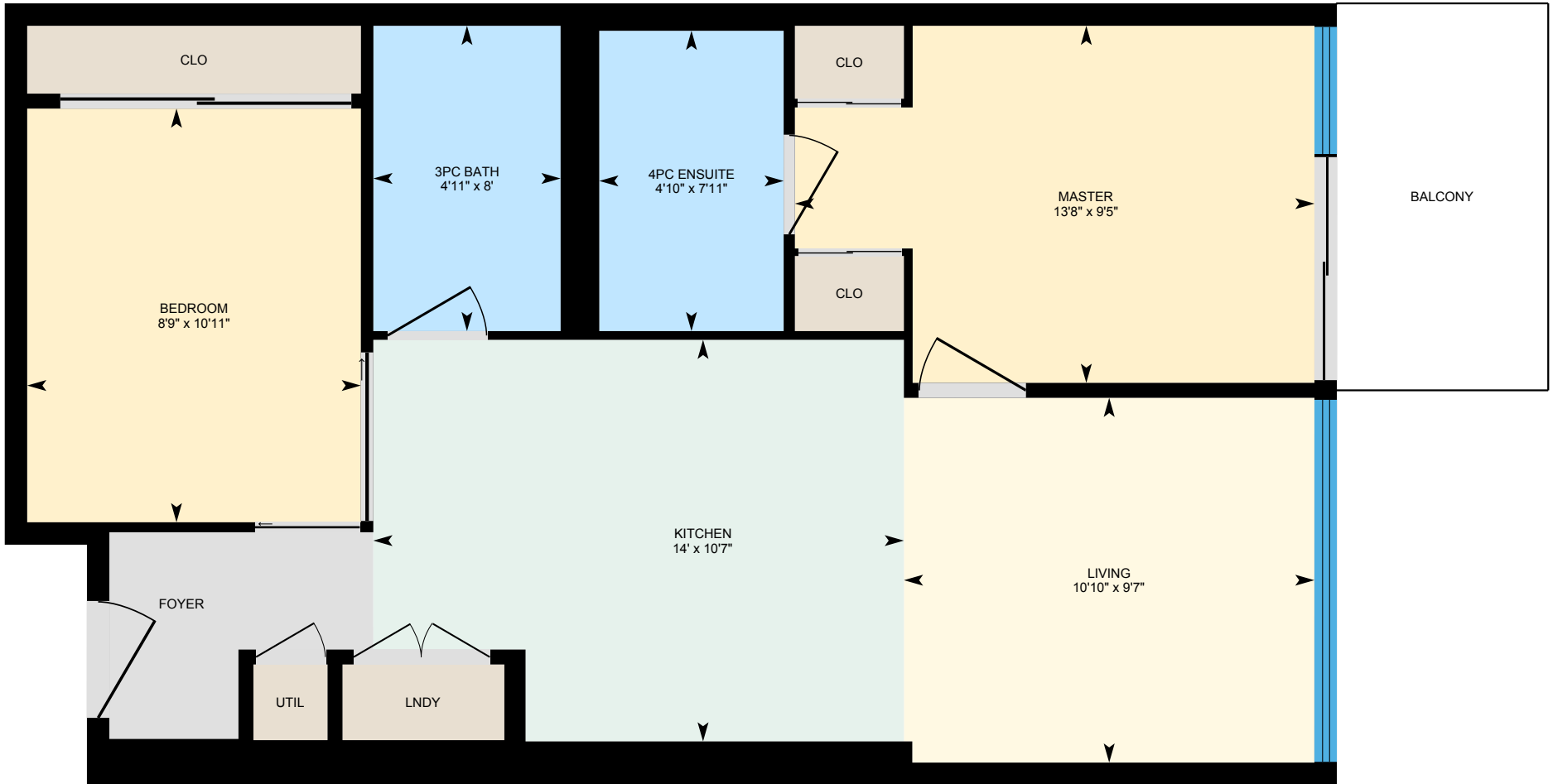
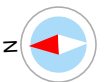

White regions are excluded from total floor area. All room dimensions and floor areas must be considered approximate and are subject to independent verification. For method of measurement please see <https://youriguide.com/measure/>.

2101-5 Soudan Ave, Toronto, ON

Property Details

Room Measurements

Only major rooms are listed. Some listed rooms may be excluded from total interior floor area (e.g. garage). Room dimensions are largest length and width; parts of room may be smaller. Room area is not always equal to product of length and width.

Main Building

MAIN FLOOR

3pc Bath: 8' x 4'11"

4pc Ensuite: 7'11" x 4'10"

Bedroom: 10'11" x 8'9"

Kitchen: 10'7" x 14'

Living: 9'7" x 10'10"

Master: 9'5" x 13'8"

Floor Area Information

For explanation of floor area calculations and method of measurement please see <https://youriguide.com/measure/>. All displayed floor areas are rounded to nearest integer. Total area is computed before rounding and may not equal to sum of displayed floor areas.

Main Building

MAIN FLOOR

Interior Area: 631 sq ft

Perimeter Wall Length: 109 ft

Total Above Grade Floor Area

Main Building Interior: 631 sq ft